

**TECHNICAL LITERATURE**

Click on the QR Code to access technical literature.



Technical Literature

**TECHNICAL SUPPORT**

For additional technical information and to learn more about Sanhua's full product line, please visit:

[sanhuausa.com](http://sanhuausa.com)

**Technical information**

<https://www.sanhuausa.com/us/en/technical-info>



WANT THE LATEST SANHUA NEWS?  
FOLLOW US



SANHUA INTERNATIONAL  
info@sanhuausa.com

**GENERAL SPECIFICATIONS**

- Applicable to fluids and refrigerants of GROUP 2:  
R-410A and R-22/R-407C
- Maximum operating pressure:  
- R-410A: 670 psig  
- R-22, R-404A, R-507, R-448A, R-449A: 500 psig
- Certifications: UL/CSA and PED declaration

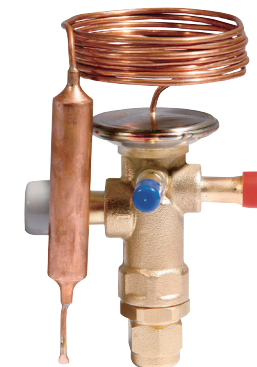

**INSTALLATION INSTRUCTIONS: RFGD, RFGF, RFGK SERIES TXV**

- 1 Place the valve into the system, orientated upright or on the side, but NOT upside-down

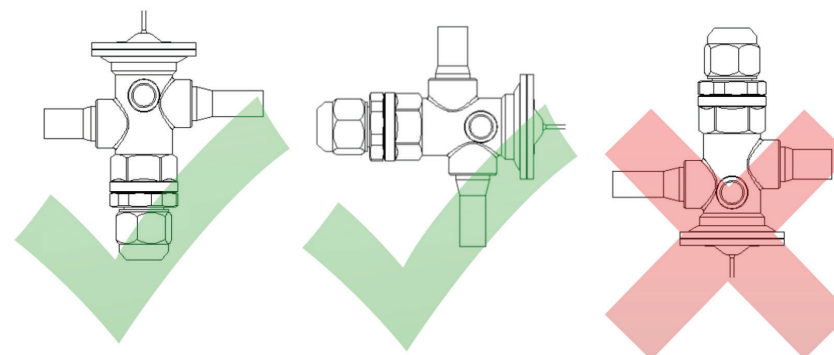

**INSTALLATION INSTRUCTIONS: RFGD, RFGF, RFGK SERIES TXV**

**2 For brazing install,**

- Wrap a wet rag around the valve to cool the internals during the brazing process.
- Uncoil the sensing bulb and move it away from the valve during brazing.
- Flow nitrogen through the valve to ensure a clean environment and prevent oxidation.
- Use a 15% silver brazing alloy and keep the torch pointed away from the valve.
- While brazing, heat the system line first, minimizing the amount of time the torch is on the TXV's connection

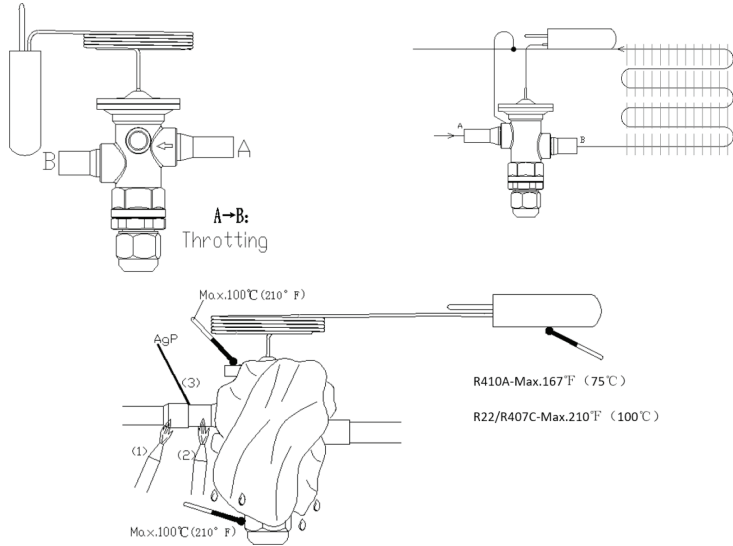

**4 Clean a section of the suction line thoroughly for the sensing bulb.**

**The bulb should be located on the suction line as close to the evaporator as possible and before the equalizer line. Never place a flame near the bulb location without first removing the bulb. Heating the bulb will over-pressurize the refrigerant inside the bulb and damage the TXV.**

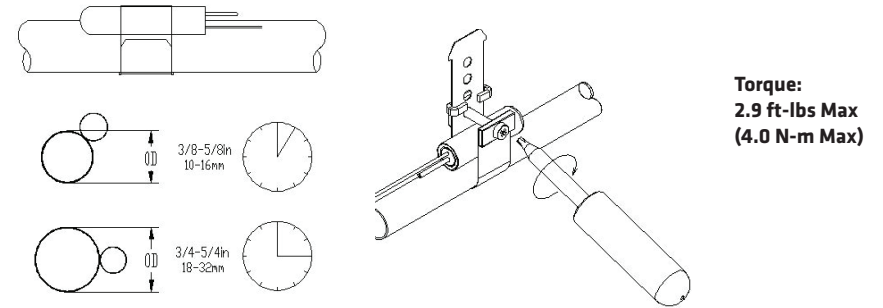

**3 For TXVs with threaded connections; Use a torque wrench to prevent leaks from over-tightening.**

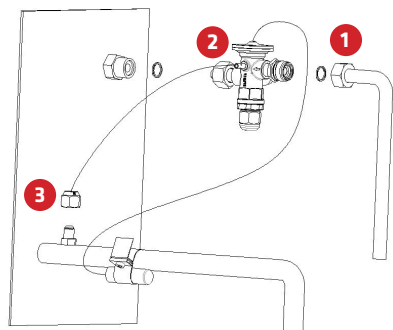

**Torque:**  
**1 2 18 to 26 ft-lbs (25 to 35 N-m)**  
**3 9 to 12 ft-lbs (12 to 17 N-m)**

**5 On adjustable TXVs, turning the adjusting stem will increase/decrease the superheat. Wait a minimum of 10 minutes between adjustments to avoid overshooting your target setting.**

