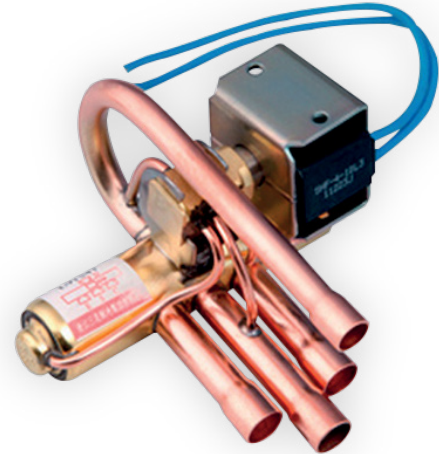

SHF SERIES**4 WAY
REVERSING VALVE**

SHF series four-way reversing valves are applicable for heat pump systems such as central, unitary and room air conditioners to realize switching between cooling mode and heating mode by changing the flow path of refrigerant.

**FEATURES**

- WIDE APPLICATION RANGE
- SUITABLE FOR COOLING CAPACITIES FROM 3.6 TO 420KW (R410A, CONDITION 2)
- SEVERAL DESIGNS AVAILABLE

GENERAL SPECIFICATION

- Applicable for all common HCFC, HFC, HFO, HC refrigerants such as: R22, R134a, R404A, R407C, R410A, R507, R450A/R513A, R32, R290, R1234ze(E), R1234yf
- Medium temperature TS min./max.: -30°C / +135°C²⁾
- Ambient temperature min./max.: -30°C / +50°C
- Relative humidity: 0 to 95% RH
- Max. operating pressure PS: ≥ 4.5 Mpa (45bar)
- Installation position:
 - Coil upwards or with body axis in horizontal alignment
 - Flow direction according to installation instruction
- Certifications: UL/CSA and declaration according to LVD or PED

4 WAY REVERSING VALVE



TABLE 1: MODELS SUITABLE FOR USAGE ON SYSTEM WITH VARIABLE SPEED (INVERTER)

| General Characteristics | | | | | | | | | | | |
|-------------------------|----------------|---|--------|---------------------|-----------------|--------|-------|-------|-------|--------------|---------|
| Valve Model | Product Number | Type of System [Variable or Fixed Speed] | Ø Port | Kv | Connections ODF | | MOP | OPD | | PED Category | |
| | | | | | ØD | ØE/S/C | | Max. | Min. | Fluid | Fluid |
| | | | [mm] | [m ³ /h] | [inch] | [inch] | [MPa] | [MPa] | [MPa] | Group 2 | Group 1 |
| SHF(L)-3H-12U-52 | 10180953202 | Variable & Fixed | 7,4 | 1,5 | 1/4 | 5/16 | 4,7 | 4 | 0,1 | 4,3 | 4,3 |
| SHF(L)-4H-23U-52 | 10180952502 | Variable & Fixed | 8 | 1,6 | 5/16 | 3/8 | 4,7 | 4 | 0,1 | 4,3 | 4,3 |
| SHF(L)-7H-34U-52 | 10180952602 | Variable & Fixed | 11,1 | 2,9 | 3/8 | 1/2 | 4,7 | 4 | 0,1 | 4,3 | 4,3 |
| SHF(L)-7H-34-52 | 10180953302 | Variable & Fixed | 11,1 | 2,9 | 3/8 | 1/2 | 4,7 | 4 | 0,1 | 4,3 | 4,3 |
| SHF(L)-7H-35-52 | 10180950002 | Variable & Fixed | 11,1 | 2,9 | 3/8 | 5/8 | 4,7 | 4 | 0,1 | 4,3 | 4,3 |
| SHF(L)-11H-34U-52 | 10180953402 | Variable & Fixed | 11,5 | 4,5 | 3/8 | 1/2 | 4,7 | 4 | 0,1 | 4,3 | 4,3 |
| SHF(L)-11H-35U-52 | 10180952402 | Variable & Fixed | 11,5 | 4,5 | 3/8 | 5/8 | 4,7 | 4 | 0,1 | 4,3 | 4,3 |
| SHF(L)-11H-45D1-52 | 10180950102 | Variable & Fixed | 11,5 | 4,5 | 1/2 | 5/8 | 4,7 | 4 | 0,1 | 4,3 | 4,3 |
| SHF(L)-11H-46D1-52 | 10180953502 | Variable & Fixed | 11,5 | 4,5 | 1/2 | 3/4 | 4,7 | 4 | 0,1 | 4,3 | 4,3 |
| SHF-14A-46 | 10325051402 | Variable & Fixed | 13,5 | 6,6 | 1/2 | 3/4 | 4,7 | 4 | 0,1 | 4,3 | 4,3 |
| SHF-20D-46-02 | 10325051602 | Variable | 17,2 | 9,5 | 1/2 | 3/4 | 4,7 | 4 | 0,1 | 4,3 | 4,3 |
| SHF-20D-47-02 | 10325055702 | Variable | 17,2 | 9,9 | 1/2 | 7/8 | 4,7 | 4 | 0,1 | 4,3 | 4,3 |
| SHF-20D-57-02 | 10325060202 | Variable | 17,2 | 9,9 | 5/8 | 7/8 | 4,7 | 4 | 0,1 | 4,3 | 4,3 |
| SHF-20D-67-02 | 10325060102 | Variable | 17,2 | 9,9 | 3/4 | 7/8 | 4,7 | 4 | 0,1 | 4,3 | 4,3 |
| SHF-35B-47-04 | 10325058802 | Variable | 20 | 14,7 | 1/2 | 7/8 | 4,7 | 4 | 0,1 | 4,3 | 4,3 |
| SHF-35B-57-04 | 10325059002 | Variable | 20 | 14,7 | 5/8 | 7/8 | 4,7 | 4 | 0,1 | 4,3 | 4,3 |
| SHF-35B-59-04 | 10325059102 | Variable | 20 | 14,7 | 5/8 | 1 1/8 | 4,7 | 4 | 0,1 | 4,3 | 4,3 |
| SHF-35B-67-04 | 10325050802 | Variable | 20 | 14,7 | 3/4 | 7/8 | 4,7 | 4 | 0,1 | 4,3 | 4,3 |
| SHF-35B-69-04 | 10325058502 | Variable | 20,9 | 14,7 | 3/4 | 1 1/8 | 4,7 | 4 | 0,1 | 4,3 | 4,3 |
| SHF-35B-79-04 | 10325058302 | Variable | 20,9 | 14,7 | 7/8 | 1 1/8 | 4,7 | 4 | 0,1 | 4,3 | 4,3 |
| SHF-50A-79 | 10325059702 | Variable & Fixed | 22,8 | 18,3 | 7/8 | 1 1/8 | 4,5 | 4 | 0,1 | 4,3 | 4,3 |
| SHF(L)-70-810-20 | 10325049401 | Variable | 28,6 | 28,5 | 1 | 1 1/4 | 4,5 | 4 | 0,15 | 4,3 | II |
| SHF(L)-70-810-21 | 10325048501 | Variable | 28,6 | 28,5 | 1 | 1 1/4 | 4,5 | 4 | 0,15 | 4,3 | II |
| SHF(L)-70-911-20 | 10325048701 | Variable | 28,6 | 28,5 | 1 1/8 | 1 3/8 | 4,5 | 4 | 0,15 | 4,3 | II |
| SHF(L)-70-911-21 | 10325048901 | Variable | 28,6 | 28,5 | 1 1/8 | 1 3/8 | 4,5 | 4 | 0,15 | 4,3 | II |
| SHF(L)-70-913-25 | 10325049301 | Variable | 28,6 | 28,5 | 1 1/8 | 1 5/8 | 4,5 | 4 | 0,15 | I | II |
| SHF(L)-70-913-23 | 10325049101 | Variable | 28,6 | 28,5 | 1 1/8 | 1 5/8 | 4,5 | 4 | 0,15 | I | II |
| SHF(L)-100-911 | 10325054502 | Variable & Fixed | 34,8 | 40,5 | 1 1/8 | 1 3/8 | 4,5 | 4 | 0,15 | I | II |
| SHF(L)-100-911-01 | 10325054602 | Variable & Fixed | 34,8 | 40,5 | 1 1/8 | 1 3/8 | 4,5 | 4 | 0,15 | I | II |
| SHF(L)-100-913 | 10325054302 | Variable & Fixed | 34,8 | 40,5 | 1 1/8 | 1 5/8 | 4,5 | 4 | 0,15 | I | II |
| SHF(L)-100-913-01 | 10325054402 | Variable & Fixed | 34,8 | 40,5 | 1 1/8 | 1 5/8 | 4,5 | 4 | 0,15 | I | II |
| SHF(L)-100-1012 | 10325053702 | Variable & Fixed | 34,8 | 40,5 | 1 1/4 | 1 1/2 | 4,5 | 4 | 0,15 | I | II |
| SHF(L)-100-1012-01 | 10325054002 | Variable & Fixed | 34,8 | 40,5 | 1 1/4 | 1 1/2 | 4,5 | 4 | 0,15 | I | II |
| SHF(L)-100-1013 | 10325053902 | Variable & Fixed | 34,8 | 40,5 | 1 1/4 | 1 5/8 | 4,5 | 4 | 0,15 | I | II |
| SHF(L)-100-1013-01 | 10325054202 | Variable & Fixed | 34,8 | 40,5 | 1 1/4 | 1 5/8 | 4,5 | 4 | 0,15 | I | II |

4 WAY REVERSING VALVE



TABLE 1: MODELS SUITABLE FOR USAGE ON SYSTEM WITH VARIABLE SPEED (INVERTER)

| General Characteristics | | | | | | | | | | | |
|-------------------------|----------------|---|--------|--------|-----------------|--------|-------|-------|-------|--------------|---------|
| Valve Model | Product Number | Type of System [Variable or Fixed Speed] | Ø Port | Kv | Connections ODF | | MOP | OPD | | PED Category | |
| | | | | | ØD | ØE/S/C | | Max. | Min. | Fluid | Fluid |
| | | | [mm] | [m³/h] | [inch] | [inch] | [MPa] | [MPa] | [MPa] | Group 2 | Group 1 |
| SHF(L)-140-1113 | 10325053402 | Variable & Fixed | 41 | 58,4 | 1 3/8 | 1 5/8 | 4,5 | 4 | 0,15 | I | II |
| SHF(L)-140-1213 | 10325053502 | Variable & Fixed | 41 | 58,4 | 1 1/2 | 1 5/8 | 4,5 | 4 | 0,15 | I | II |
| SHF(L)-140-1214 | 10325053302 | Variable & Fixed | 41 | 58,4 | 1 1/2 | 1 3/4 | 4,5 | 4 | 0,15 | I | II |
| SHF(L)-140-1313 | 10325053602 | Variable & Fixed | 41 | 58,4 | 1 5/8 | 1 5/8 | 4,5 | 4 | 0,15 | I | II |
| SHF(L)-175-1217 | 10325054902 | Variable & Fixed | 46,4 | 70,5 | 1 1/2 | 2 1/8 | 4,5 | 4 | 0,15 | I | II |
| SHF(L)-175-1317 | 10325055002 | Variable & Fixed | 46,4 | 70,5 | 1 5/8 | 2 1/8 | 4,5 | 4 | 0,15 | I | II |
| SHF(L)-210-1321 | 10325055102 | Variable & Fixed | 50 | 84,4 | 1 5/8 | 2 5/8 | 4,5 | 4 | 0,15 | I | II |
| SHF(L)-350-1721 | 10325055202 | Variable & Fixed | 59 | 138,4 | 2 1/8 | 2 5/8 | 4,5 | 4 | 0,15 | I | II |
| SHF(L)-420-2125 | 10325055302 | Variable & Fixed | 69 | 177 | 2 5/8 | 3 1/8 | 4,5 | 4 | 0,15 | I | II |

TABLE 2: MODELS OPTIMIZED FOR USAGE ON SYSTEM WITH FIXED SPEED (ON/OFF COMPRESSORS)

| General Characteristics | | | | | | | | | | | |
|-------------------------|----------------|---|--------|--------|-----------------|--------|-------|-------|-------|--------------|---------|
| Valve Model | Product Number | Type of System [Variable or Fixed Speed] | Ø Port | Kv | Connections ODF | | MOP | OPD | | PED Category | |
| | | | | | ØD | ØE/S/C | | Max. | Min. | Fluid | Fluid |
| | | | [mm] | [m³/h] | [inch] | [inch] | [MPa] | [MPa] | [MPa] | Group 2 | Group 1 |
| SHF-20D-46-01 | 10325051502 | Fixed | 17,2 | 9,5 | 1/2 | 3/4 | 4,7 | 4 | 0,1 | 4,3 | 4,3 |
| SHF-20D-47-01 | 10325057402 | Fixed | 17,2 | 9,9 | 1/2 | 7/8 | 4,7 | 4 | 0,1 | 4,3 | 4,3 |
| SHF-20D-57-01 | 10325057302 | Fixed | 17,2 | 9,9 | 5/8 | 7/8 | 4,7 | 4 | 0,1 | 4,3 | 4,3 |
| SHF-20D-67-01 | 10325050102 | Fixed | 17,2 | 9,9 | 3/4 | 7/8 | 4,7 | 4 | 0,1 | 4,3 | 4,3 |
| SHF-35B-47-01 | 10325058702 | Fixed | 20 | 14,7 | 1/2 | 7/8 | 4,7 | 4 | 0,1 | 4,3 | 4,3 |
| SHF-35B-57-01 | 10325058902 | Fixed | 20 | 14,7 | 5/8 | 7/8 | 4,7 | 4 | 0,1 | 4,3 | 4,3 |
| SHF-35B-59-01 | 10325050202 | Fixed | 20 | 14,7 | 5/8 | 1 1/8 | 4,7 | 4 | 0,1 | 4,3 | 4,3 |
| SHF-35B-67-01 | 10325050702 | Fixed | 20 | 14,7 | 3/4 | 7/8 | 4,7 | 4 | 0,1 | 4,3 | 4,3 |
| SHF-35B-69-01 | 10325058402 | Fixed | 20,9 | 14,7 | 3/4 | 1 1/8 | 4,7 | 4 | 0,1 | 4,3 | 4,3 |
| SHF-35B-79-01 | 10325052702 | Fixed | 20,9 | 14,7 | 7/8 | 1 1/8 | 4,7 | 4 | 0,1 | 4,3 | 4,3 |
| SHF(L)-70-810-10 | 10325048302 | Fixed | 28,6 | 28,5 | 1 | 1 1/4 | 4,5 | 4 | 0,15 | 4,3 | II |
| SHF(L)-70-810-11 | 10325048402 | Fixed | 28,6 | 28,5 | 1 | 1 1/4 | 4,5 | 4 | 0,15 | 4,3 | II |
| SHF(L)-70-911-10 | 10325048602 | Fixed | 28,6 | 28,5 | 1 1/8 | 1 3/8 | 4,5 | 4 | 0,15 | 4,3 | II |
| SHF(L)-70-911-11 | 10325048802 | Fixed | 28,6 | 28,5 | 1 1/8 | 1 3/8 | 4,5 | 4 | 0,15 | 4,3 | II |
| SHF(L)-70-913-15 | 10325049202 | Fixed | 28,6 | 28,5 | 1 1/8 | 1 5/8 | 4,5 | 4 | 0,15 | I | II |
| SHF(L)-70-913-13 | 10325049002 | Fixed | 28,6 | 28,5 | 1 1/8 | 1 5/8 | 4,5 | 4 | 0,15 | I | II |

NOMINAL OPERATING CONDITIONS

| Nominal Operating Conditions | Condition 1 | Condition 2 |
|-------------------------------|-------------|-------------|
| Condensing Temperature t_c | 38°C | 54,4°C |
| Evaporating Temperature t_e | 5°C | 7,2°C |
| Superheat Δt_{sc} | 5K | 5K |
| Subcooling Δt_{sr} | 0K | 5K |

Notes for Capacity Selection Tables: 1) Pressure drop is valid for flow from ØC to ØS or from ØE to ØS
2) R407C data based on dew point conditions

4 WAY REVERSING VALVE

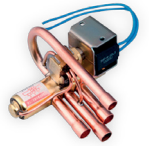

| Capacity Selection Table | | | | | | | | |
|--------------------------|--|----------------|----------------|----------------|----------------|----------------|----------------|----------------|
| Valve Size | Nominal Cooling Capacity (condition 1) | | | | | | | |
| | R407C ²⁾ | | R410A | | R134a | | R404A / R507 | |
| | ΔP: 0,1 bar | ΔP: 0,2 bar | ΔP: 0,1 bar | ΔP: 0,2 bar | ΔP: 0,1 bar | ΔP: 0,2 bar | ΔP: 0,1 bar | ΔP: 0,2 bar |
| | [kW] | [kW] | [kW] | [kW] | [kW] | [kW] | [kW] | [kW] |
| SHF(L)-3H | 3,3 | 4,7 | 4,0 | 5,7 | 2,6 | 3,7 | 2,9 | 4,0 |
| SHF(L)-4H | 3,6 | 5,0 | 4,3 | 6,1 | 2,8 | 4,0 | 3,1 | 4,3 |
| SHF(L)-7H | 6,5 | 9,1 | 7,8 | 11,0 | 5,1 | 7,2 | 5,5 | 7,8 |
| SHF(L)-11H | 10,0 | 14,2 | 12,1 | 17,1 | 7,9 | 11,1 | 8,6 | 12,1 |
| SHF-14A-46 | 14,7 | 20,8 | 17,7 | 25,1 | 11,5 | 16,3 | 12,6 | 17,8 |
| SHF-20D-46 | 21,2 | 29,9 | 25,5 | 36,1 | 16,6 | 23,5 | 18,1 | 25,6 |
| SHF-20D-xx | 22,1 | 31,2 | 26,6 | 37,7 | 17,3 | 24,5 | 18,9 | 26,7 |
| SHF-35B | 32,7 | 46,3 | 39,5 | 55,9 | 25,7 | 36,3 | 28,1 | 39,7 |
| SHF-50A-79 | 40,8 | 57,7 | 49,2 | 69,6 | 32,0 | 45,2 | 34,9 | 49,4 |
| SHF(L)-70 | 63,5 | 89,8 | 76,6 | 108,4 | 49,8 | 70,4 | 54,4 | 76,9 |
| SHF(L)-100 | 90,2 | 127,6 | 108,9 | 154,0 | 70,8 | 100,1 | 77,3 | 109,3 |
| SHF(L)-140 | 130,1 | 184,0 | 157,1 | 222,1 | 102,0 | 144,3 | 111,5 | 157,6 |
| SHF(L)-175 | 157,0 | 222,1 | 189,6 | 268,1 | 123,2 | 174,2 | 134,6 | 190,3 |
| SHF(L)-210 | 188,0 | 265,9 | 227,0 | 321,0 | 147,5 | 208,6 | 161,1 | 227,8 |
| SHF(L)-350 | 308,3 | 436,0 | 372,2 | 526,4 | 241,8 | 342,0 | 264,2 | 373,6 |
| SHF(L)-420 | 394,3 | 557,6 | 476,0 | 673,2 | 309,3 | 437,4 | 337,8 | 477,8 |

| Capacity Selection Table | | | | | | | | |
|--------------------------|--|----------------|----------------|----------------|----------------|----------------|----------------|----------------|
| Valve Size | Nominal Cooling Capacity (condition 2) | | | | | | | |
| | R407C ²⁾ | | R410A | | R134a | | R404A / R507 | |
| | ΔP: 0,1 bar | ΔP: 0,2 bar | ΔP: 0,1 bar | ΔP: 0,2 bar | ΔP: 0,1 bar | ΔP: 0,2 bar | ΔP: 0,1 bar | ΔP: 0,2 bar |
| | [kW] | [kW] | [kW] | [kW] | [kW] | [kW] | [kW] | [kW] |
| SHF(L)-3H | 3,0 | 4,3 | 3,6 | 5,0 | 2,4 | 3,4 | 2,4 | 3,4 |
| SHF(L)-4H | 3,2 | 4,6 | 3,8 | 5,4 | 2,6 | 3,7 | 2,6 | 3,7 |
| SHF(L)-7H | 5,9 | 8,3 | 6,9 | 9,7 | 4,7 | 6,6 | 4,7 | 6,6 |
| SHF(L)-11H | 9,1 | 12,9 | 10,7 | 15,1 | 7,3 | 10,3 | 7,3 | 10,3 |
| SHF-14A-46 | 13,4 | 18,9 | 15,7 | 22,2 | 10,7 | 15,1 | 10,7 | 15,1 |
| SHF-20D-46 | 19,3 | 27,3 | 22,5 | 31,9 | 15,4 | 21,7 | 15,4 | 21,7 |
| SHF-20D-xx | 20,1 | 28,4 | 23,5 | 33,2 | 16,0 | 22,7 | 16,0 | 22,6 |
| SHF-35B | 29,8 | 42,2 | 34,9 | 49,3 | 23,8 | 33,7 | 23,8 | 33,6 |
| SHF-50A-79 | 37,1 | 52,5 | 43,4 | 61,4 | 29,6 | 41,9 | 29,6 | 41,8 |
| SHF(L)-70 | 57,8 | 81,8 | 67,6 | 95,7 | 46,1 | 65,2 | 46,1 | 65,2 |
| SHF(L)-100 | 82,2 | 116,2 | 96,1 | 136,0 | 65,6 | 92,7 | 65,5 | 92,6 |
| SHF(L)-140 | 118,5 | 167,5 | 138,6 | 196,0 | 94,5 | 133,7 | 94,4 | 133,5 |
| SHF(L)-175 | 143,0 | 202,2 | 167,3 | 236,7 | 114,1 | 161,4 | 114,0 | 161,2 |
| SHF(L)-210 | 171,2 | 242,1 | 200,3 | 283,3 | 136,6 | 193,2 | 136,5 | 193,0 |
| SHF(L)-350 | 280,7 | 397,0 | 328,5 | 464,6 | 224,1 | 316,9 | 223,8 | 316,4 |
| SHF(L)-420 | 359,0 | 507,8 | 420,1 | 594,2 | 286,5 | 405,2 | 286,2 | 404,7 |

4 WAY REVERSING VALVE



DIMENSIONS - VALVES

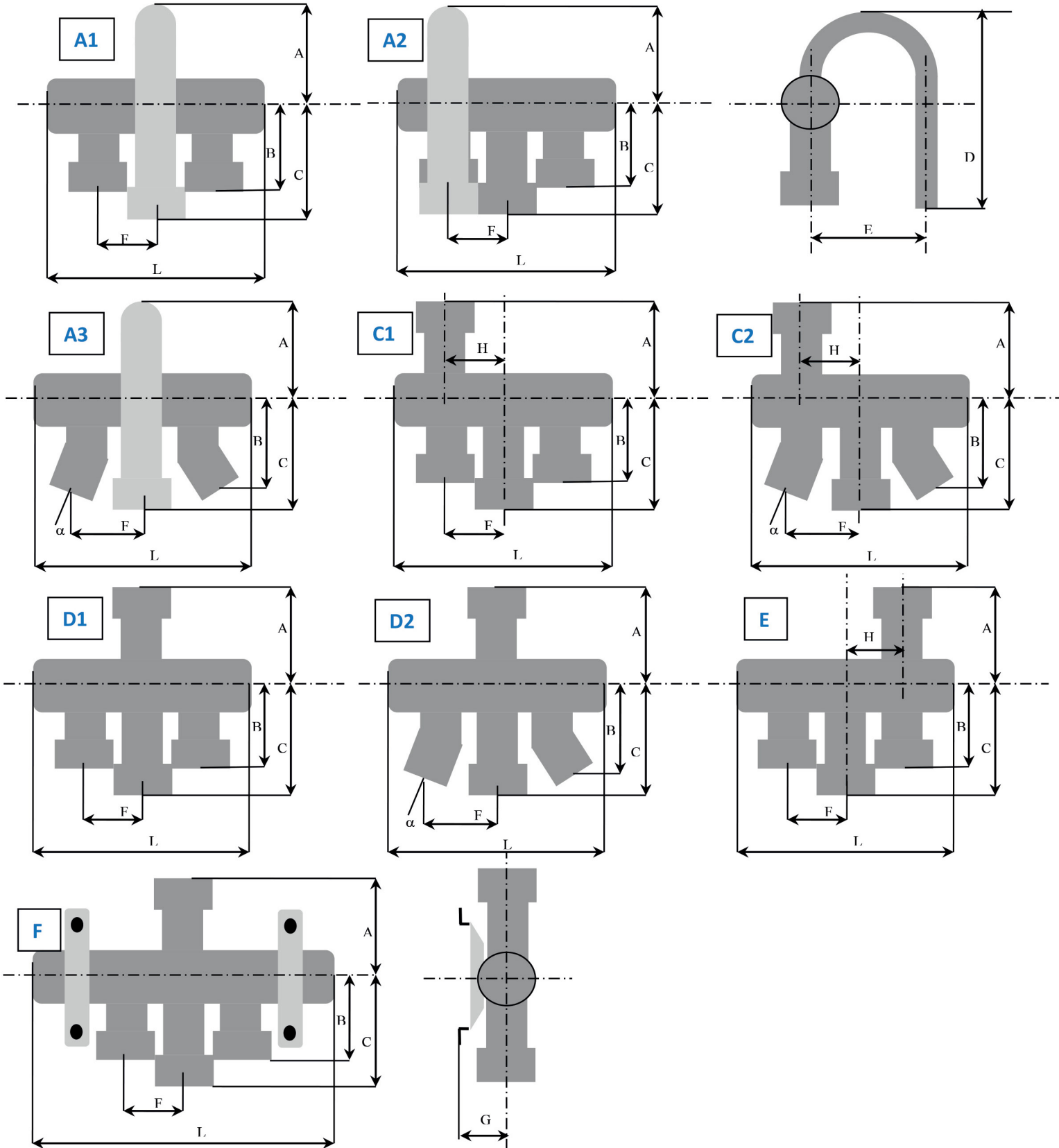

4 WAY REVERSING VALVE



TABLE 3: MODELS SUITABLE FOR USAGE ON SYSTEM WITH VARIABLE SPEED (INVERTER)

| Valve Model | Valve Style | Dimensions - Valves | | | | | | | | | | Weight |
|--------------------|-------------|---------------------|-------|-------|-------|------|------|------|------|------|---------|--------|
| | | L | A | B | C | D | E | F | G | H | Angle α | |
| | | [mm] | [mm] | [mm] | [mm] | [mm] | [mm] | [mm] | [mm] | [mm] | [°] | |
| SHF(L)-3H-12U-52 | A1 | 88,2 | 38,5 | 38 | 50 | 88,5 | 43 | 11 | - | - | 0 | 0,2 |
| SHF(L)-4H-23U-52 | A1 | 94,4 | 43 | 50 | 62 | 105 | 43 | 12 | - | - | 0 | 0,2 |
| SHF(L)-7H-34U-52 | A1 | 113 | 52 | 59 | 71 | 119 | 52 | 16 | - | - | 0 | 0,3 |
| SHF(L)-7H-34-52 | D1 | 113 | 52 | 59 | 71 | - | - | 16 | - | - | 0 | 0,3 |
| SHF(L)-7H-35-52 | D2 | 113 | 52 | 57 | 72 | - | - | 23,5 | - | 16 | 0 | 0,3 |
| SHF(L)-11H-34U-52 | A1 | 115,5 | 51 | 59 | 71 | 119 | 52 | 16 | - | - | 0 | 0,3 |
| SHF(L)-11H-35U-52 | A3 | 115,5 | 51 | 57 | 71 | 119 | 52 | 23,5 | - | - | 15 | 0,3 |
| SHF(L)-11H-45D1-52 | C2 | 117 | 52 | 62 | 87 | - | - | 25 | - | 16 | 15 | 0,32 |
| SHF(L)-11H-46D1-52 | C2 | 117 | 52 | 82 | 87 | - | - | 32,5 | - | 16 | 20 | 0,35 |
| SHF-14A-46 | D1 | 163 | 67 | 83 | 95 | - | - | 23,8 | - | - | 0 | 0,72 |
| SHF-20D-46-02 | D1 | 183,6 | 67 | 83 | 95 | - | - | 28,6 | - | - | 0 | 0,75 |
| SHF-20D-47-02 | D1 | 183,6 | 67 | 83 | 95 | - | - | 28,6 | - | - | 0 | 0,75 |
| SHF-20D-57-02 | D1 | 183,6 | 67 | 83 | 95 | - | - | 28,6 | - | - | 0 | 0,75 |
| SHF-20D-67-02 | D1 | 183,6 | 67 | 83 | 95 | - | - | 28,6 | - | - | 0 | 0,75 |
| SHF-35B-47-04 | D1 | 212,2 | 82 | 87 | 100 | - | - | 33 | - | - | 0 | 1,3 |
| SHF-35B-57-04 | D1 | 212,2 | 82 | 87 | 100 | - | - | 33 | - | - | 0 | 1,3 |
| SHF-35B-59-04 | D1 | 212,2 | 82 | 87 | 100 | - | - | 33 | - | - | 0 | 1,3 |
| SHF-35B-67-04 | D1 | 212,2 | 82 | 87 | 100 | - | - | 33 | - | - | 0 | 1,3 |
| SHF-35B-69-04 | D1 | 212,2 | 82 | 87 | 100 | - | - | 33 | - | - | 0 | 1,3 |
| SHF-35B-79-04 | D1 | 212,2 | 82 | 87 | 100 | - | - | 33 | - | - | 0 | 1,3 |
| SHF-50A-79 | D1 | 217 | 91 | 96 | 109 | - | - | 33 | - | - | 0 | 2,1 |
| SHF(L)-70-810-20 | D1 | 303 | 111 | 117 | 131 | - | - | 46 | - | - | 0 | 3 |
| SHF(L)-70-810-21 | F | 303 | 111 | 117 | 154 | - | - | 46 | 58 | - | 0 | 3 |
| SHF(L)-70-911-20 | D1 | 303 | 111 | 117 | 154 | - | - | 46 | - | - | 0 | 3 |
| SHF(L)-70-911-21 | F | 321 | 111 | 117 | 131 | - | - | 49 | 58 | - | 0 | 3,5 |
| SHF(L)-70-913-25 | D1 | 321 | 111 | 117 | 131 | - | - | 49 | - | - | 0 | 3,5 |
| SHF(L)-70-913-23 | F | 321 | 111 | 117 | 131 | - | - | 49 | 58 | - | 0 | 3,5 |
| SHF(L)-100-911 | D1 | 321 | 111 | 117 | 131 | - | - | 49 | - | - | 0 | 3,5 |
| SHF(L)-100-911-01 | F | 303 | 111 | 117 | 131 | - | - | 46 | 58 | - | 0 | 3 |
| SHF(L)-100-913 | D1 | 303 | 111 | 117 | 154 | - | - | 46 | - | - | 0 | 3 |
| SHF(L)-100-913-01 | F | 303 | 111 | 117 | 154 | - | - | 46 | 58 | - | 0 | 3 |
| SHF(L)-100-1012 | D1 | 321 | 111 | 117 | 131 | - | - | 49 | - | - | 0 | 3,5 |
| SHF(L)-100-1012-01 | F | 321 | 111 | 117 | 131 | - | - | 49 | 58 | - | 0 | 3,5 |
| SHF(L)-100-1013 | D1 | 321 | 111 | 117 | 131 | - | - | 49 | - | - | 0 | 3,5 |
| SHF(L)-100-1013-01 | F | 321 | 111 | 117 | 131 | - | - | 49 | 58 | - | 0 | 3,5 |
| SHF(L)-140-1113 | F | 390 | 135,6 | 148,7 | 168,7 | - | - | 58 | 63 | - | 0 | 7,2 |
| SHF(L)-140-1213 | F | 390 | 135,6 | 148,7 | 168,7 | - | - | 58 | 63 | - | 0 | 7,2 |
| SHF(L)-140-1214 | F | 390 | 135,6 | 148,7 | 168,7 | - | - | 58 | 63 | - | 0 | 7,2 |
| SHF(L)-140-1313 | F | 390 | 135,6 | 148,7 | 168,7 | - | - | 58 | 63 | - | 0 | 7,2 |
| SHF(L)-175-1217 | F | 390 | 135,6 | 148,7 | 198 | - | - | 58 | 63 | - | 0 | 7,6 |
| SHF(L)-175-1317 | F | 390 | 135,6 | 148,7 | 198 | - | - | 58 | 63 | - | 0 | 7,6 |
| SHF(L)-210-1321 | F | 452 | 135,6 | 148,7 | 198 | - | - | 71,5 | 63 | - | 0 | 8,7 |
| SHF(L)-350-1721 | F | 531 | 176,5 | 184 | 240 | - | - | 75 | 82,5 | - | 0 | 22 |
| SHF(L)-420-2125 | F | 611,7 | 176,5 | 184 | 240 | - | - | 93 | 82,5 | - | 0 | 26 |

4 WAY REVERSING VALVE

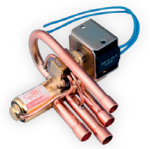
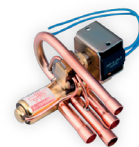

TABLE 4: MODELS OPTIMIZED FOR USAGE ON SYSTEM WITH FIXED SPEED (ON/OFF COMPRESSORS)

| Dimensions - Valves | | | | | | | | | | | | |
|---------------------|-------------|-------|------|------|------|------|------|------|------|------|----------------|--------|
| Valve Model | Valve Style | L | A | B | C | D | E | F | G | H | Angle α | Weight |
| | | [mm] | [mm] | [mm] | [mm] | [mm] | [mm] | [mm] | [mm] | [mm] | [°] | [kg] |
| SHF-20D-46-01 | D1 | 183,6 | 67 | 83 | 95 | - | - | 28,6 | - | - | 0 | 0,75 |
| SHF-20D-47-01 | D1 | 183,6 | 67 | 83 | 95 | - | - | 28,6 | - | - | 0 | 0,75 |
| SHF-20D-57-01 | D1 | 183,6 | 67 | 83 | 95 | - | - | 28,6 | - | - | 0 | 0,75 |
| SHF-20D-67-01 | D1 | 183,6 | 67 | 83 | 95 | - | - | 28,6 | - | - | 0 | 0,75 |
| SHF-35B-47-01 | D1 | 212,2 | 82 | 87 | 100 | - | - | 33 | - | - | 0 | 1,3 |
| SHF-35B-57-01 | D1 | 212,2 | 82 | 87 | 100 | - | - | 33 | - | - | 0 | 1,3 |
| SHF-35B-59-01 | D1 | 212,2 | 82 | 87 | 100 | - | - | 33 | - | - | 0 | 1,3 |
| SHF-35B-67-01 | D1 | 212,2 | 82 | 87 | 100 | - | - | 33 | - | - | 0 | 1,3 |
| SHF-35B-69-01 | D1 | 212,2 | 82 | 87 | 100 | - | - | 33 | - | - | 0 | 1,3 |
| SHF-35B-79-01 | D1 | 212,2 | 82 | 87 | 100 | - | - | 33 | - | - | 0 | 1,3 |
| SHF(L)-70-810-10 | D1 | 303 | 111 | 117 | 131 | - | - | 46 | - | - | 0 | 3 |
| SHF(L)-70-810-11 | D1 | 303 | 111 | 117 | 131 | - | - | 46 | - | - | 0 | 3 |
| SHF(L)-70-911-10 | D1 | 303 | 111 | 117 | 154 | - | - | 46 | - | - | 0 | 3 |
| SHF(L)-70-911-11 | F | 321 | 111 | 117 | 131 | - | - | 49 | 58 | - | 0 | 3,5 |
| SHF(L)-70-913-15 | D1 | 321 | 111 | 117 | 131 | - | - | 49 | - | - | 0 | 3,5 |
| SHF(L)-70-913-13 | F | 321 | 111 | 117 | 131 | - | - | 49 | 58 | - | 0 | 3,5 |

4 WAY REVERSING VALVE



| Coil Characteristics | | | | | | | | | | | | |
|--------------------------|--------------|-------------|--------------------------------------|--------------|--------------|---------------|-------------------|------|----|-----------------|-----------------|----------------|
| Coil Model ¹⁾ | Winding Code | Part Number | Electrical Function/ Connection Type | Cable Length | Power Supply | Rated Voltage | Power Consumption | | | Protection Clas | Insulat. Class | Max. Op. Temp. |
| | | | | | | | AC | AC | DC | | | |
| | | | | | | | 50Hz | 60Hz | | | | |
| [mm] | [-] | [V] | [W] | [W] | [W] | [-] | [-] | [°C] | | | | |
| SQ-A25 22G-00 0001 | SHF-4-10L3 | 10805029102 | Lead Wires | 500 | AC | 220-240 | 4,5 | 3,5 | - | IP54 | B ²⁾ | 130 |
| SQ-A25 200-00 0001 | SHF-4-10L2 | 10805027002 | Lead Wires | 500 | AC | 200 | 4,5 | 3,5 | - | | | |
| SQ-A25 100-00 0001 | SHF-4-10L1 | 10805023602 | Lead Wires | 500 | AC | 100 | 4,5 | 3,5 | - | | | |
| SQ-A25 11A-00 0001 | SHF-4-10L4 | 10805150302 | Lead Wires | 500 | AC | 110-120 | 4,5 | 3,5 | - | | | |
| SQ-A25 024-00 0001 | SHF-4-10L5 | 10805227602 | Lead Wires | 500 | AC | 24 | 4,5 | 3,5 | - | | | |
| SQ-A25 26H-00 0001 | SHF-4-10L6 | 10805231902 | Lead Wires | 500 | AC | 265-277 | 4,5 | 3,5 | - | | | |
| SQ-A25 22G-00 0870 | SHF-4-10L3 | 10805240702 | Lead Wires | 1500 | AC | 220-240 | 4,5 | 3,5 | - | | | |
| SQ-A25 11A-00 0840 | SHF-4-10L4 | 10805240802 | Lead Wires | 1500 | AC | 110-120 | 4,5 | 3,5 | - | | | |
| SQ-A25 024-00 0161 | SHF-4-10L5 | 10805023002 | Lead Wires | 1500 | AC | 24 | 4,5 | 3,5 | - | | | |
| SQ-A47 22G-00 0001 | SHF-4-10FA5 | 10805263402 | Spade (Faston) ³⁾ | - | AC | 220-240 | 6 | 5 | - | IP00 | F ²⁾ | 155 |
| SQ-A47 220-00 0001 | SHF-4-10FA1 | 10805273402 | Spade (Faston) ³⁾ | - | AC | 220 | 6 | 5 | - | | | |
| SQ-A47 11B-00 0001 | SHF-4-10FA2 | 10805273302 | Spade (Faston) ³⁾ | - | AC | 120 | 6 | 5 | - | | | |
| SQ-A47 10A-00 0001 | SHF-4-10FA3 | 10805268702 | Spade (Faston) ³⁾ | - | AC | 100-110 | 6 | 5 | - | | | |
| SQ-A47 024-00 0001 | SHF-4-10FA4 | 10805263302 | Spade (Faston) ³⁾ | - | AC | 24 | 6 | 5 | - | | | |
| SQ-A47 26H-00 0001 | SHF-4-10FA6 | 10805273502 | Spade (Faston) ³⁾ | - | AC | 265-277 | 6 | 5 | - | | | |
| SQ-D44 012-00 0001 | SHF-4-10FA8 | 10805231802 | Spade (Faston) ³⁾ | - | DC | 12 | - | - | 10 | IP54 | B ²⁾ | 130 |
| SQ-D44 024-00 0001 | SHF-4-10FA9 | 10805070102 | Spade (Faston) ³⁾ | - | DC | 24 | - | - | 11 | | | |
| SQ-A27 100-00 0001 | - | 10805063202 | Bi-stable/Lead W. | 500 | AC | 100 | 18 | 18 | - | IP54 | B ²⁾ | 130 |
| SQ-A27 200-00 0001 | - | 10805063802 | Bi-stable/Lead W. | 500 | AC | 200 | 18 | 18 | - | | | |
| SQ-A27 20K-00 0001 | - | 10805222902 | Bi-stable/Lead W. | 500 | AC | 220-240 | 18 | 18 | - | | | |
| SQ-D27 012-00 0001 | - | 10805069302 | Bi-stable/Lead W. | 500 | DC | 12 | - | - | 20 | | | |

- Note:** 1) Every coil is applicable to all above specified valve models
 2) Max ambient temperature up to + 50°C
 3) Wire Harness for coil with Faston connector available as accessory

ACCESSORY

| Wire Harness | | |
|------------------|-------------|-------------------|
| Model | Part Number | Cable Length [mm] |
| SQ-000000-090028 | 20805136302 | 1200 |
| SQ-000000-090029 | 20805149202 | 2000 |

4 WAY REVERSING VALVE



DIMENSIONS - COILS

Coils with Lead Wires (SQ-A25 Series)

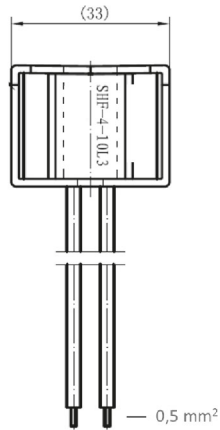
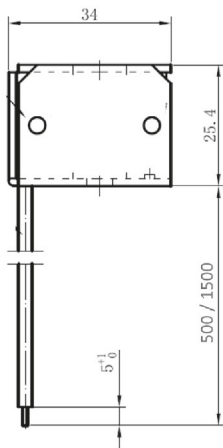

Bistable coil (SQ-A/D27)

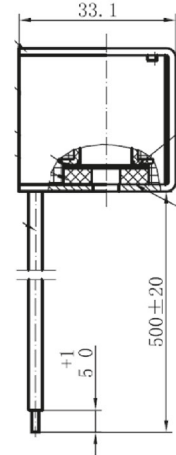
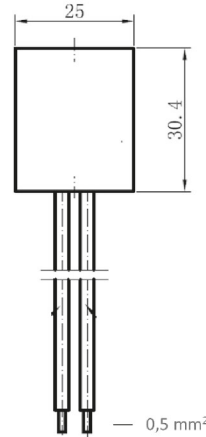

Coils with Spade Connections (SQ-A47 and SQ-D44 Series)

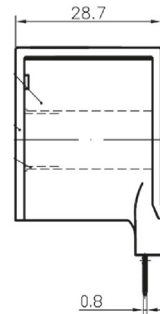
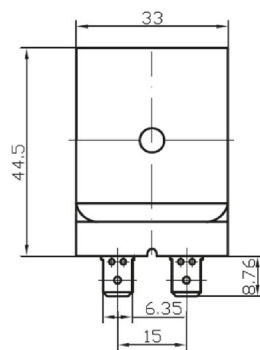

Connecteur Faston avec câble (1200mm) (SQ-000000-090028) / **Code Sanhua : SHF-56026**

