

JYQ SERIES | *Compensator*

JYQ series charge compensators are designed to work in heat pump applications. It pulls certain quantity of refrigerant out of circulation during the heating mode, then return the refrigerant back into circulation during the cooling mode. By storing this excess refrigerant in the compensator, the system would have better control of the refrigerant and the system efficiency would increase due to operating at a reduced high side pressure.



FEATURES

- SOLID COPPER SOLDER CONNECTION
- MINIMIZE PRESSURE DROP
- GUARANTEE THE MAXIMUM WORKING PRESSURE
- POWDER COATED SURFACE CAN SURVIVE 500 HOURS OF SALT SPRAY TEST
- EXCELLENT ANTIMICHAEL
- SHOCK AND VIBRATION PERFORMANCE: USING STEEL CASING

GENERAL SPECIFICATION

- Applicable refrigerant: HFC, HCFC and HC
- Applicable medium temperature: $-30^{\circ}\text{C} \sim +120^{\circ}\text{C}$ ($-22^{\circ}\text{F} \sim +240^{\circ}\text{F}$)
- Applicable ambient temperature: $-30^{\circ}\text{C} \sim +55^{\circ}\text{C}$ ($-22^{\circ}\text{F} \sim +131^{\circ}\text{F}$)
- Maximum working pressure: 4.83MPa
- Certification: UL, CSA

JYQ SERIES | Compensator

DIMENSIONS TECHNICAL PARAMETERS

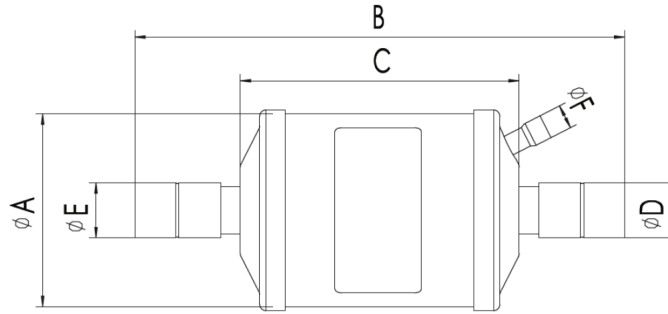

Model	Diameter "A" (in)	"B" (in)	"C" (in)	Connections "D" & "E" ODF (in)	Liquid Connection "F" ODF (in)	Internal Volume (in ³)	Holding Capacity (oz)	
							R-410A	
							75°F	125°F
JYQ-A23060-004	3.5	7.19	3.33	3/4	3/8	23	15	13
JYQ-A36060-005	3.5	8.92	5.06	3/4	3/8	36	24	20
JYQ-A45060-008	3.5	10.16	6.30	3/4	3/8	45	29	24
JYQ-A55060-006	3.5	11.04	7.19	3/4	3/8	55	36	28
JYQ-A66060-007	3.5	12.06	8.20	3/4	3/8	66	42	35
JYQ-A78060-010	3.5	14.11	10.25	3/4	3/8	78	50	42
JYQ-A89060-009	3.5	15.86	12.00	3/4	3/8	89	56	47
JYQ-B13060-011	3.5	18.26	14.40	3/4	3/8	130	83	69
JYQ-A23070-001	3.5	7.19	3.33	7/8	3/8	23	15	13
JYQ-A31070-001	3.5	8.14	4.28	7/8	3/8	31	20	17
JYQ-A36070-001	3.5	8.92	5.06	7/8	3/8	36	24	20
JYQ-A45070-001	3.5	10.16	6.30	7/8	3/8	45	30	25
JYQ-A66070-001	3.5	12.06	8.20	7/8	3/8	66	43	36
JYQ-A78070-001	3.5	14.11	10.25	7/8	3/8	78	51	43
JYQ-A89070-001	3.5	15.86	12.00	7/8	3/8	89	57	48
JYQ-B13070-001	3.5	18.26	14.40	7/8	3/8	130	84	70