

## SMV SERIES | Brass Service Valve



The SMV series bar stock service valves are applicable for air conditioning or refrigeration systems requiring a means to shut off refrigerant flow. The valves can be used for system servicing, evacuation, and refrigerant charging.

### FEATURES

- LOW PRESSURE DROP
- MAY BE CONFIGURED TO MEET CUSTOMER'S REQUIREMENTS
- 100 PERCENT LEAK CHECKED

### GENERAL SPECIFICATION

- Applicable for all common HCFC and HFC refrigerants such as: UL Approved Refrigerants:  
R22, R134a, R407C, R404A, R410A, R32, R507, R1234yf, R1234ze(E), R448A, R449A, R450A, R452A, R513A, R12, R500, R502, R123, R152a, R417A, R422A, R422D, R426A, R427A, R290, R600, R600a, R407A, R454C, R455A, R23, R125, R124, R407F, R401A, R401B, R401C, R422, R444A, R444B, R445A, R446A, R447A, R447B, R449B, R451A, R451B, R452B, R452C, R454A, R454B, R455B, R457A, R457B, R457C, R467A, R459A, R459B, R516A, R236fa, R245fa, R1336mzz(E), R1336mzz(Z), R143a, R471A, R515A, R515B
- Fluid temperature range: -22°F to +250°F
- Maximum operating pressure: 700 psig
- Contraction: SMV-JA3 though JA9 brass bar-stock body, SMV-8, -15, 17 forged brass body
- Installation Position: liquid, suction and discharge line in any position
- Certifications: UL File Number 12770

### TECHNICAL PARAMETERS

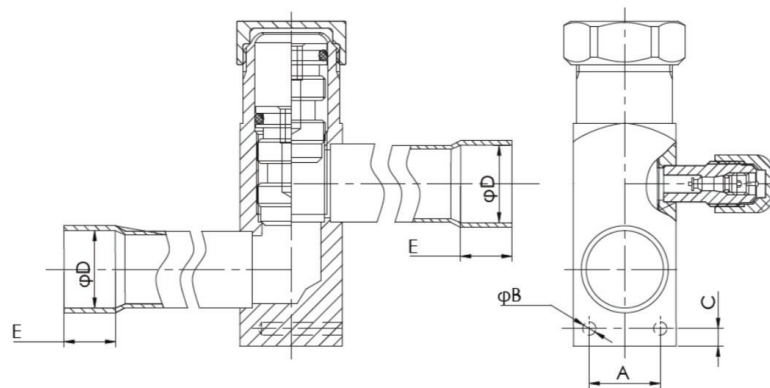

Solder Connection



## SMV SERIES | Brass Service Valve

### SOLDER CONNECTIONS

Model	Conn Size (in)	Dimensions (in)					Thread Size
		A	B	C	D	E	F
SMV-JA3Y	3/8	0.42±0.02	0.14±0.004	0.14	0.38	0.31±0.04	/
SMV-JA4Y	1/2	0.70±0.02	0.14±0.004	0.14	0.50	0.38±0.04	/
SMV-JA5Y	5/8	0.70±0.02	0.14±0.004	0.14	0.63	0.56±0.04	/
SMV-JA6Y	3/4	0.70±0.02	0.14±0.004	0.14	0.75	0.62±0.04	/
SMV-JA7Y	7/8	0.70±0.02	0.14±0.004	0.14	0.88	0.75±0.04	/
SMV-JA8Y	1	0.70±0.02	0.14±0.004	0.14	1.00	0.59±0.04	/
SMV-JA9Y	1-1/8	0.70±0.02	0.14±0.004	0.14	1.13	0.59±0.04	/
SMV-8JA3Y	3/8	0.42±0.02	0.14±0.004	0.14	0.38	0.31±0.04	/
SMV-15JA4Y	1/2	0.70±0.02	0.14±0.004	0.14	0.50	0.38±0.04	/
SMV-15JA5Y	5/8	0.70±0.02	0.14±0.004	0.14	0.63	0.56±0.04	/
SMV-15JA6Y	3/4	0.70±0.02	0.14±0.004	0.14	0.75	0.62±0.04	/
SMV-17JA7Y	7/8	0.70±0.02	0.14±0.004	0.14	0.88	0.75±0.04	/

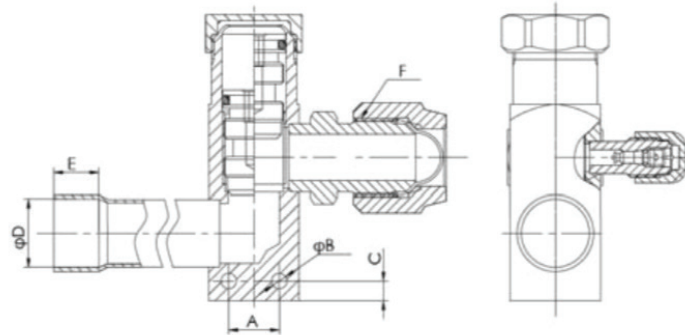

Solder/Flare Nut

### SOLDER / FLARE NUTS

Model	Conn Size (in)	Dimensions (in)					Thread Size
		A	B	C	D	E	F
SMV-JA3	3/8	0.42±0.02	0.14±0.004	0.14	0.38	0.31±0.04	5/8-18UNF
SMV-JA4	1/2	0.70±0.02	0.14±0.004	0.14	0.50	0.38±0.04	3/4-16UNF
SMV-JA5	5/8	0.70±0.02	0.14±0.004	0.14	0.63	0.56±0.04	7/8-14UNF
SMV-JA6	3/4	0.70±0.02	0.14±0.004	0.14	0.75	0.62±0.04	1-1/16-14UNS
SMV-JA7	7/8	0.70±0.02	0.14±0.004	0.14	0.88	0.75±0.04	1-1/16-14UNS
SMV-8JA3	3/8	0.42±0.02	0.14±0.004	0.14	0.38	0.31±0.04	5/8-18UNF
SMV-15JA4	1/2	0.70±0.02	0.14±0.004	0.14	0.50	0.38±0.04	3/4-16UNF
SMV-15JA5	5/8	0.70±0.02	0.14±0.004	0.14	0.63	0.56±0.04	7/8-14UNF
SMV-15JA6	3/4	0.70±0.02	0.14±0.004	0.14	0.75	0.62±0.04	1-1/16-14UNS
SMV-17JA7	7/8	0.70±0.02	0.14±0.004	0.14	0.88	0.75±0.04	1-1/16-14UNS